

STENSBALLE

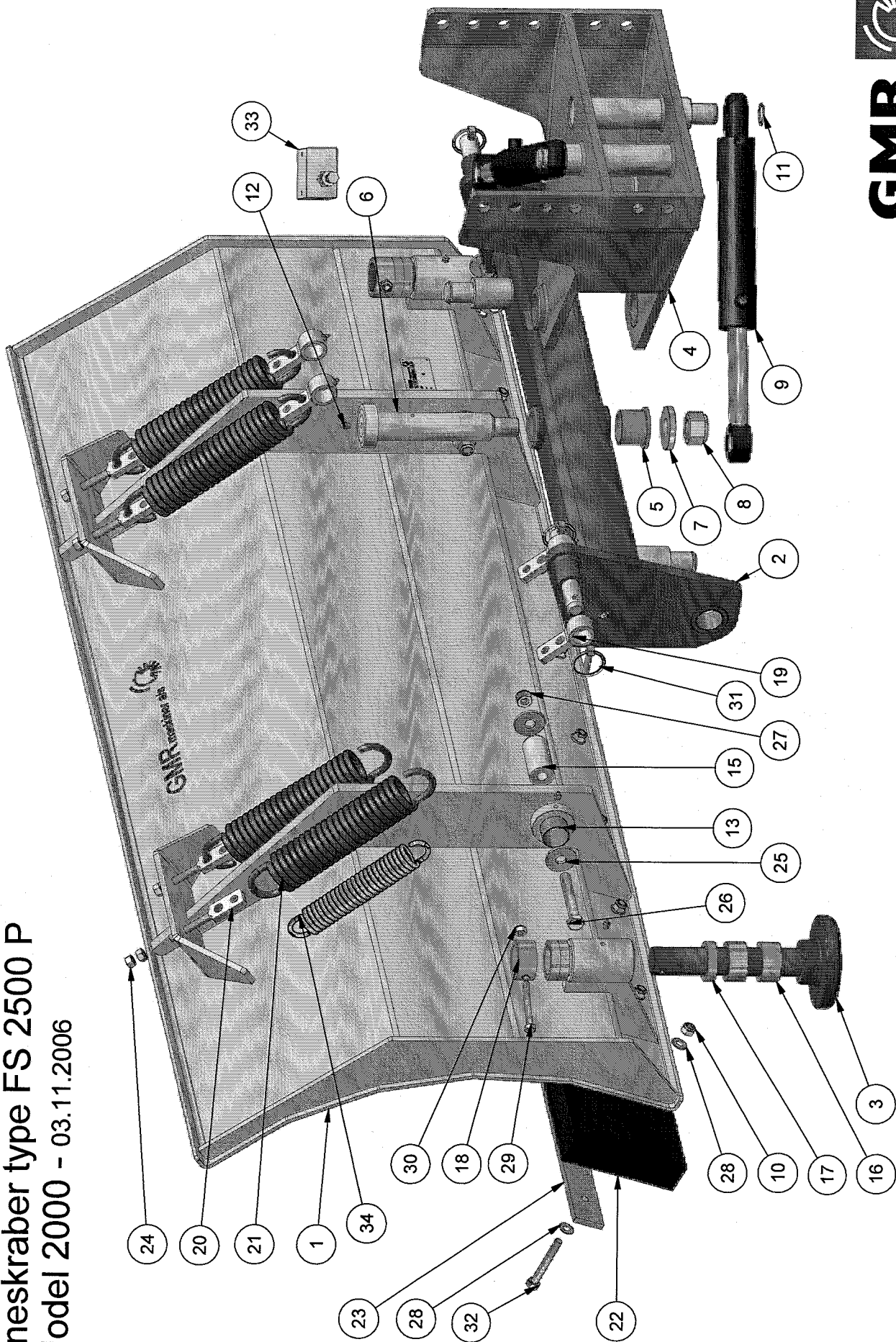

Sneskraber type FS 2500 P

Model 2000 - 03.11.2006



GMR
maskiner a/s

STENSBALLE

Sneskraber type FS 2500 P

Model 2000

03.11.2006

| Pos. | Benævnelse | Antal | Res. nummer | Bemærkning |
|------|-------------------------|-------|-------------|------------|
| 1 | Sneblad | 1 | 80-125-100 | |
| 2 | Hovedbom | 1 | 80-122-200 | |
| 3 | Slæbesko | 2 | 80-122-030 | |
| 4 | Hulrækkeramme | 1 | 89-902-200 | |
| 5 | Bronzebøsning | 2 | 80-122-002 | |
| 6 | Drejebolt | 1 | 80-122-020 | |
| 7 | Skive for drejenagle | 1 | 53-622-004 | |
| 8 | Låsemøtrik | 1 | 31-111-030 | |
| 9 | Cylinder | 2 | 01-650-208 | |
| 10 | Låsemøtrik | 10 | 31-101-012 | |
| 11 | Låsering | 4 | 20-101-032 | |
| 12 | Smørenippel | 1 | 57-000-010 | |
| 13 | Bronzebøsning | 4 | 54-640-040 | |
| 14 | Smørenippel | 10 | 57-000-008 | |
| 15 | Kipaksel | 2 | 80-122-001 | |
| 16 | Justerring – bred | 4 | 80-122-035 | |
| 17 | Justerring – smal | 6 | 80-122-036 | |
| 18 | Spændering | 2 | 80-122-037 | |
| 19 | Fjederholder – nederste | 4 | 80-122-040 | |
| 20 | Fjederholder – øverste | 4 | 80-122-045 | |
| 21 | Trækfjeder - yderste | 4 | 61-699-525 | |
| 22 | Gummiskær | 1 | 80-125-006 | |
| 23 | Holder for Gummiskær | 1 | 80-125-110 | |
| 24 | Møtrik | 8 | 31-001-012 | |
| 25 | Svær skive | 4 | 36-150-016 | |
| 26 | Maskinbolt | 2 | 28-116-110 | |

STENSALLE

Sneskraber type FS 2500 P

Model 2000

03.11.2006

| Pos. | Benævnelse | Antal | Res. nummer | Bemærkning |
|------|-----------------------|-------|-------------|------------|
| 27 | Låsemøtrik | 2 | 31-101-016 | |
| 28 | Facetskive | 24 | 36-300-012 | |
| 29 | Maskinbolt | 2 | 28-110-080 | |
| 30 | Låsemøtrik | 2 | 31-101-010 | |
| 31 | Ringsplit | 4 | 38-000-011 | |
| 32 | Maskinbolt | 10 | 28-112-090 | |
| 33 | Chokventil | 1 | LGH700Y | |
| 34 | Trækfjeder - inderste | 4 | 61-386-532 | |
| 35 | | | | |
| 36 | | | | |
| 37 | | | | |
| 38 | | | | |
| 39 | | | | |
| 40 | | | | |
| 41 | | | | |
| 42 | | | | |
| 43 | | | | |
| 44 | | | | |
| 45 | | | | |
| 46 | | | | |
| 47 | | | | |
| 48 | | | | |
| 49 | | | | |
| 50 | | | | |
| 51 | | | | |
| 52 | | | | |

STENSBALLE

Sneskraber type FS/P

Model 2005 - 09.03.2005

Tillæg for ny slæbesko

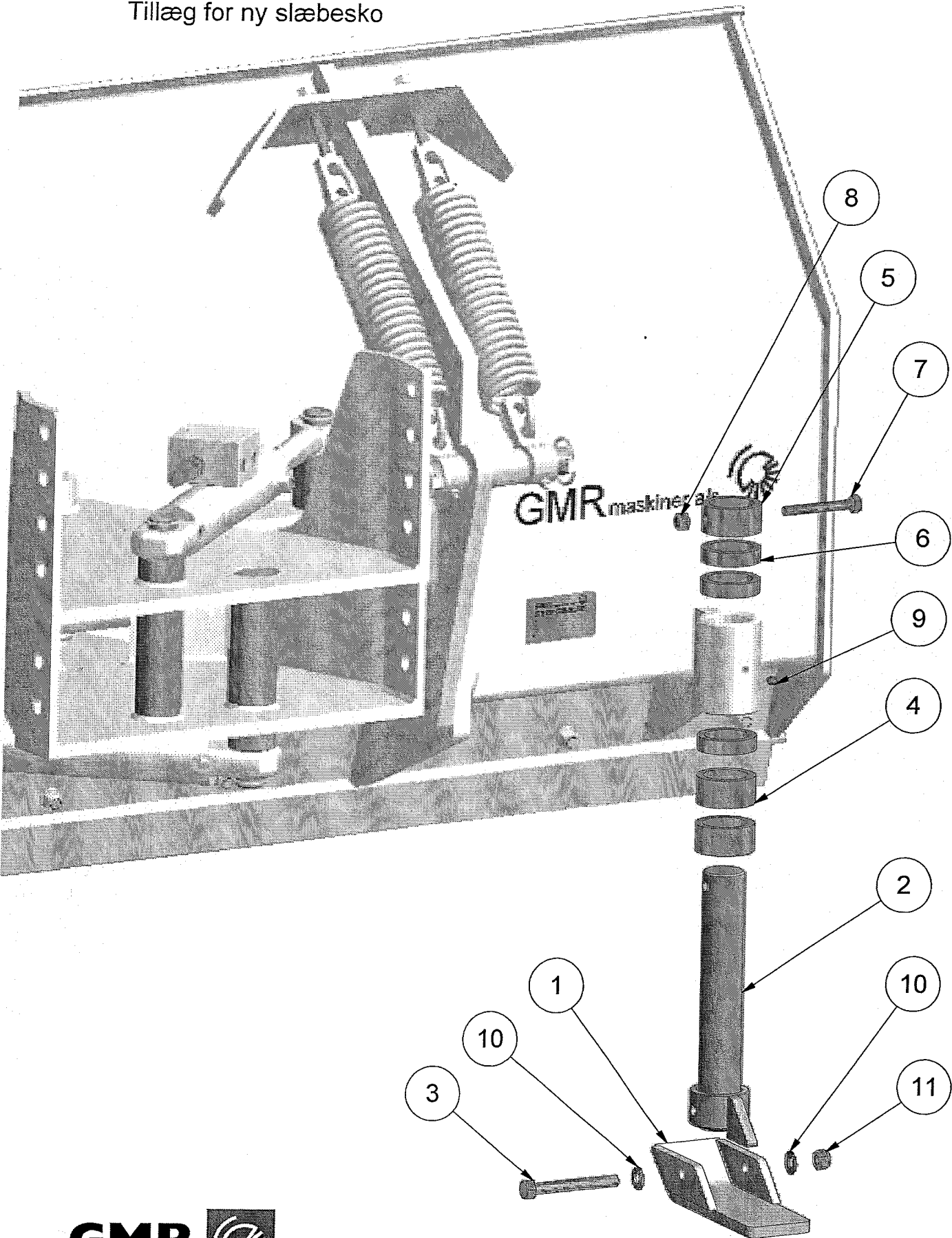

STENSBALLE



Sneskraber type FS/P

Model 2005 – Tillæg for ny slæbesko

09.03.2005

| Pos. | Benævnelse | Antal | Res. nummer | Bemærkning |
|------|-------------------|-------|-------------|------------|
| 1 | Slæbesko | 2 | 77-501-450 | |
| 2 | Ben for slæbesko | 2 | 77-501-455 | |
| 3 | Maskinbolt | 2 | 28-112-100 | |
| 4 | Justerring - bred | 4 | 80-122-035 | |
| 5 | Spændering | 2 | 80-122-037 | |
| 6 | Justerring - smal | 6 | 80-122-036 | |
| 7 | Maskinbolt | 2 | 28-110-080 | |
| 8 | Låsemøtrik | 2 | 31-101-010 | |
| 9 | Smørenippel | 2 | 57-000-008 | |
| 10 | Facetskive | 4 | 36-300-012 | |
| 11 | Låsemøtrik | 2 | 31-101-012 | |
| 12 | | | | |
| 13 | | | | |
| 14 | | | | |
| 15 | | | | |
| 16 | | | | |
| 17 | | | | |
| 18 | | | | |
| 19 | | | | |
| 20 | | | | |
| 21 | | | | |
| 22 | | | | |
| 23 | | | | |
| 24 | | | | |

GMR
maskiner a/s



Saturnvej 17 . DK 8700 Horsens
Tlf.: +45 75 64 36 11 . Fax: +45 75 64 53 20
E-mail: stensballe@gmr.dk . <http://www.gmr.dk>